

Plain Sight Flow indicator

Technical Datasheet



This straight through sight glass is ideal for you to visually check the presence, colour and condition of a liquid

Suitable for viewing flow conditions in applications with intermittent flow, entrained air and partially filled pipes. A special version for use with steam and condensate uses borosilicate glass to ensure good long-term visibility.

The style plain sight glass has a spout cast in the body and is used to check for the presence of a liquid where there is intermittent flow, partially filled lines or entrained air. It can be used in vertical or horizontal lines. The integral drip lip makes it ideal for leak detection.

A flow switch can be fitted to the indicator to give an alarm if the flow moves above or below a preset value. For ease of maintenance the glass can be removed and replaced.

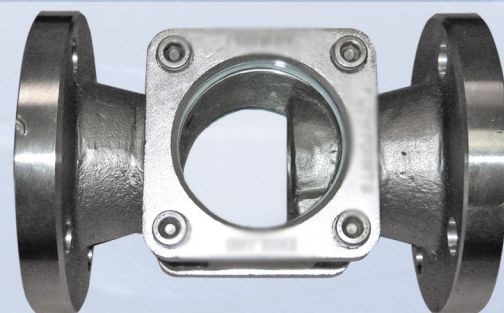

Features

Pressure:	up to 60 bar
Temperature:	up to 250°C
Sizes:	15 to 200mm
Materials:	Carbon steel or Stainless steel
Connections:	BSP, NPT, ANSI150, ANSI300, PN16
CE marked and fully PED compliant	

Dimensions

Nominal Bore	Length L1	Length L2	Width W	Depth D	Clear-view C
15/20mm	85	130	63	60	42
25mm	95	140	72	66	48
40mm	120	180	102	84	62
50mm	150	220	118	106	77
80mm	N/A	260	160	170	100
100mm	N/A	260	196	170	100
150mm	N/A	360	304	220	150
200mm	N/A	460	370	280	200

Mounting position

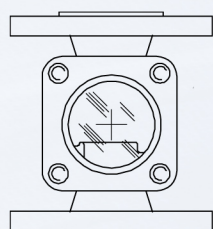

Vertical lines

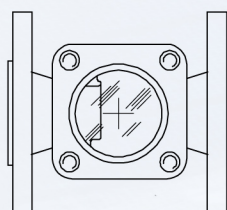

Horizontal lines

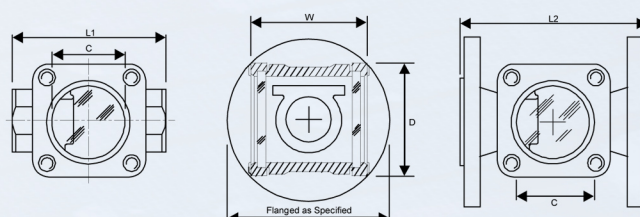

Specifications are subject to change without notice.
Product images are for illustrative purposes only.