

Ball Flow Indicator

Technical Data-Sheet

Features

Mechanical Flow Indicator for liquids, gases or aggressive metering substances. The liquid enters a valve housing and lifts the ball from the valve seat placed in glass dome.

Clear flow indication
16 bar pressure & 200 °C temperature capability
Excellent chemical compatibility due to materials of construction
Competitively priced
Operates over a wide flow range
No routine maintenance needed
Unrivalled flow and pressure drop performance
Manufactured in stainless steel
When calibrated flow indicators are not needed, the Ball Flow Indicator will satisfy more requirements within pipe sizes from 8 mm to 40 mm
Connections: BSP(F) parallel and NPT(F) taper

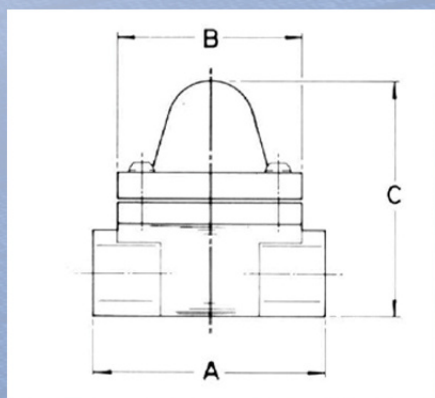
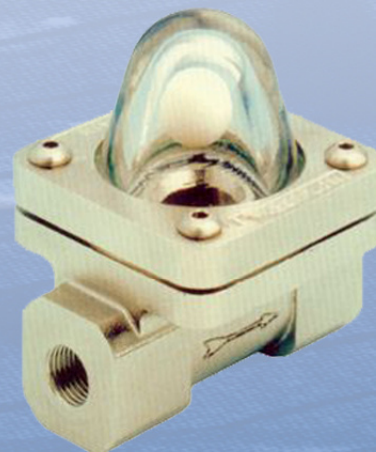

Materials

Body	Stainless steel (ANC4B)
Clamp ring	Stainless steel
Ball	PTFE 'Teflon'
Glass Dome	Annealed borosilicate
'O' Ring	Viton
Gasket	Klingsil C-4400
Fastener	Stainless steel

Dimensions & Weights

Bore	[mm]	8	10	15	20	25	32	40
Size	[inch]	1/4	3/8	1/2	3/4	1	1 1/4	1 1/2
Weight	[kg]	0.72	0.69	0.65	1.30	1.25	2.50	2.35
'A' Overall Length	[mm]	76	76	76	89	89	117	117
'B' Width (Clamp)	[mm]	63	63	63	63	63	75	75
'C' Overall Height	[mm]	79	79	79	95	95	125	125

Metering substances

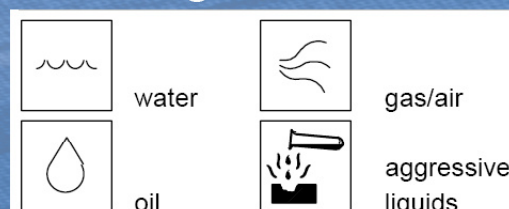

Not recommendable for dark or contaminated liquids

Flow requirements

Size	[mm]	8	10	15	20	25	32	40
Min Flow	[l/min]	0.1	0.1	0.1	2.4	2.7	11.0	16.0
Out of socket	[l/min]	1.0	1.0	1.0	5.2	5.5	16.0	21.0
Pressure Drop-2m/sec	[bar]	0.13	0.16	0.19	0.16	0.40	0.20	0.23

Applications

Maintaining demineralised water rinsing essential to electronics component manufacture
Showing the presence of condensate in steam return lines
Indicating chemical dosing on water treatment plants
Ensuring that flow of cooling water is maintained to specialised medical equipment
Detecting changes in colour and condition of liquids during processing

Mounting position

